

P6063B PASSIVE PROBE

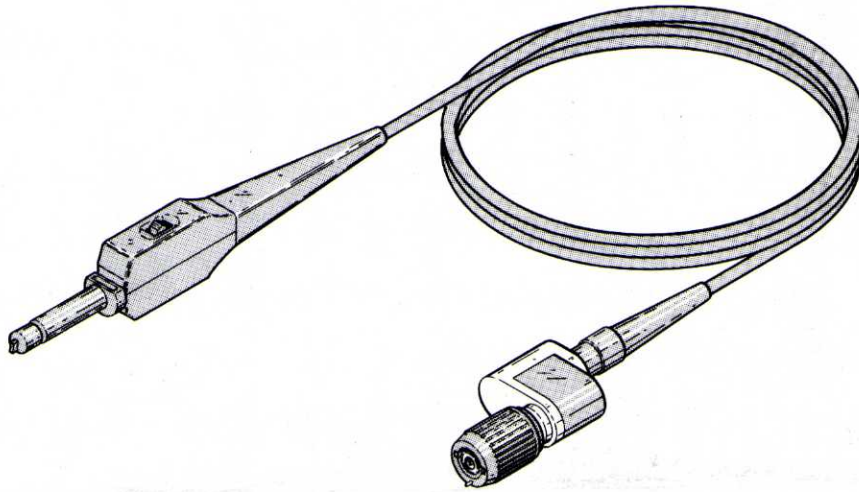

The P6063B Probe is a passive probe with 1X or 10X selectable attenuation for use with dc to 225 MHz oscilloscopes having an input capacitance range of 15-24 pF and an input resistance of 1 M Ω .

The attenuation (1X or 10X) is selected by a slide switch, on the probe body, that also has the capability of changing the volts/division readout circuitry in readout oscilloscopes to include the attenuation ratio of the probe.

A ground reference push button on the body of the probe permits the user to obtain a ground reference with either 1X or 10X attenuation. This feature can also be used to identify which trace of a multitrace display reflects the signal from the probe.

Adjustable frequency compensation is provided in the compensation box to match the probe to the oscilloscope input.

The P6063B Probe is available in two lengths: 3.5-foot (1.1 meter) and 6-foot (1.8 meter). Either probe length terminates in a compensation box with a BNC connector. The BNC connector is compatible with both readout and non-readout oscilloscopes.

P6063B PROBE

SPECIFICATIONS

ELECTRICAL

Attenuation: 1X position; same as oscilloscope specification.
10X position; within 3% (oscilloscope input, 1 M Ω , within 2%).

Input Resistance: 1X position; same as oscilloscope specification.
10X position; 10 M Ω , within 0.5% (oscilloscope input, 1 M Ω within 2%).

Approximate Input Capacitance (with probe connected and compensated in 10X position):

	3.5 foot (1.1 m) Probe	6 foot (1.8 m) Probe
1X	80 pF	105 pF
10X	11 pF	14 pF

Input Impedance: See Fig. 1 and 2. Typical parallel reactance (X_p) and resistance (R_p) vs. frequency.

Compensation Range: 15 pF to 24 pF.

Approximate Bandwidths (-3 dB) with probe compensated in 10X position:

	3.5 foot (1.1 m) Probe	6 foot (1.8 m) Probe
1X	12 MHz	6.7 MHz
10X	* 200 MHz	* 200 MHz

*Oscilloscope bandwidth must be \geq 225 MHz.

Maximum Input Voltage (See Fig. 3):

1X position; 350 V (dc + peak ac) to 850 kHz derated to 70 V at 10 MHz, 3.5 foot probe.

1X position; 200 V (dc + peak ac) to 850 kHz derated to 70 V at 10 MHz, 6.0 foot probe.

10X position; 500 V (dc + peak ac) to 4.5 MHz derated to 30 V at 200 MHz, both 3.5 and 6.0 foot probes.

ENVIRONMENTAL

Probe operates within specifications over the following ranges:

Temperature: -15°C (5°F) to $+75^{\circ}\text{C}$ (167°F).

Altitude: To 4572 meters (15,000 feet).

PHYSICAL

Net weight (including accessories):

3.5 foot (1.1 m) Probe: 128 grams (4.5 oz.).

6 foot (1.8 m) Probe: 142 grams (5.0 oz.).

OPERATING CONSIDERATIONS

CIRCUIT LOADING

1X Switch Position:

This position loads circuit more than the 10X position. The test point will see the oscilloscope input impedance (1 M Ω and 15 to 24 pF) paralleled by the capacitance of the probe cable and compensation network.

10X Switch Position:

Although the probe dc input resistance is 10 M Ω , it can load a high-impedance circuit and distort the test signal. Therefore, when possible, select low-impedance test points. Also, as signal frequency increases, probe input impedance decreases, which increases the loading effect of the probe (see Fig. 1, 2, and 3).

PROBE GROUNDING

A passive probe is a capacitive divider for high-frequency components. Inductance introduced by a long signal or ground lead will form a series resonant circuit that will "ring" if driven by a signal containing significant frequency components at or above circuit resonance. These oscillations can appear on the oscilloscope display and distort the true waveform. Ground leads and probe tip connections should be kept as short as possible to maintain the best fidelity.

GROUND REFERENCE

When the Ground Reference push button switch is pressed with the slide switch in the 1X or 10X attenuation position, the test signal is grounded through the probe 9 M Ω resistor.

P6063B PROBE

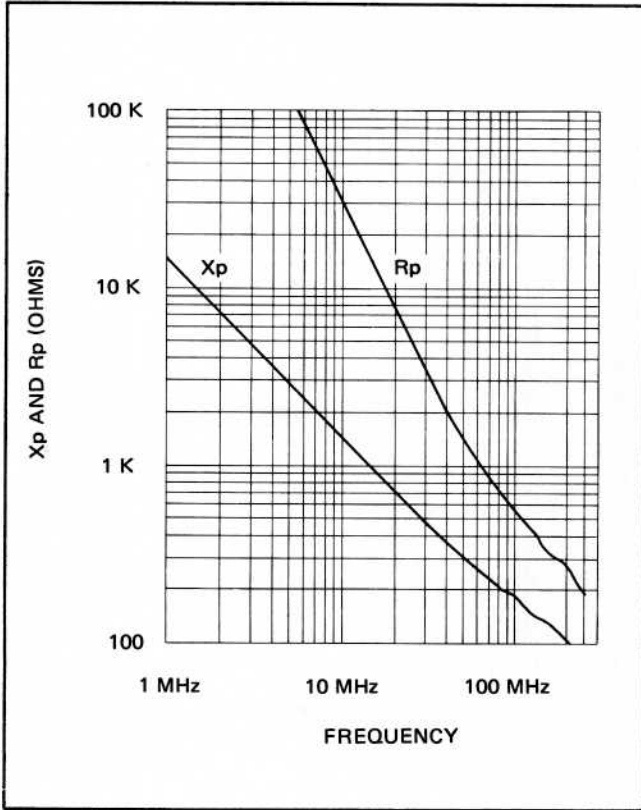

Fig. 1 Typical parallel reactance (X_p) and resistance (R_p) vs. frequency for 3.5 foot (1.1 meter) probe.

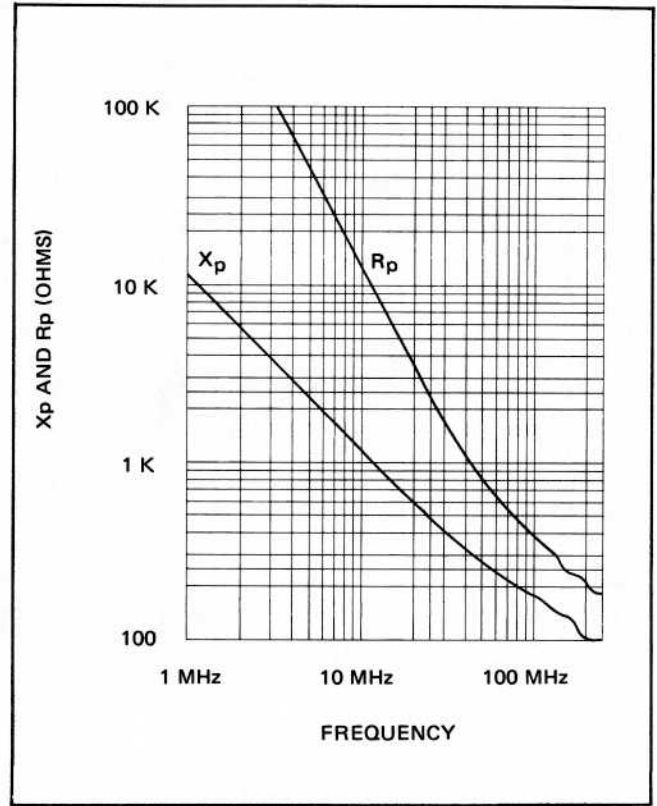

Fig 2 Typical parallel reactance (X_p) and resistance (R_p) vs. frequency for 6 foot (1.8 meter) probe.

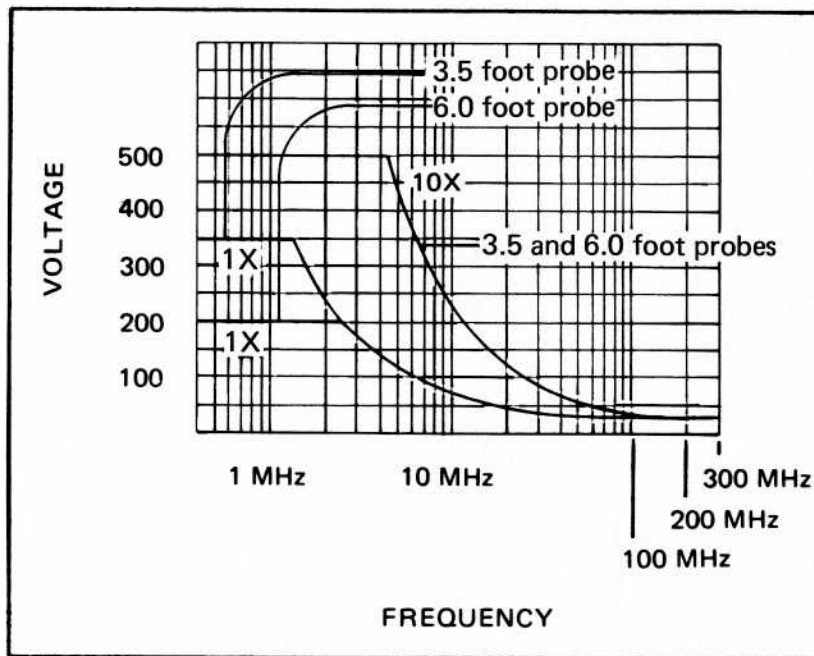

Fig. 3 Input voltage vs. frequency.

PROBE COMPENSATION

LOW-FREQUENCY COMPENSATION

If the P6063B Probe is transferred from one instrument or input channel to another, the low-frequency compensation will usually require adjustment.

Low-Frequency Compensation Procedure

1. Make sure probe attenuation switch is in 10X position.
2. Touch probe tip to oscilloscope calibrator output connector and display several cycles of calibrator square wave at approximately 4 divisions in amplitude. (Use a 1 kHz square wave from an alternate source if calibrator output is not available on oscilloscope.)
3. Adjust probe compensation for best flat top on display (see Fig. 4).

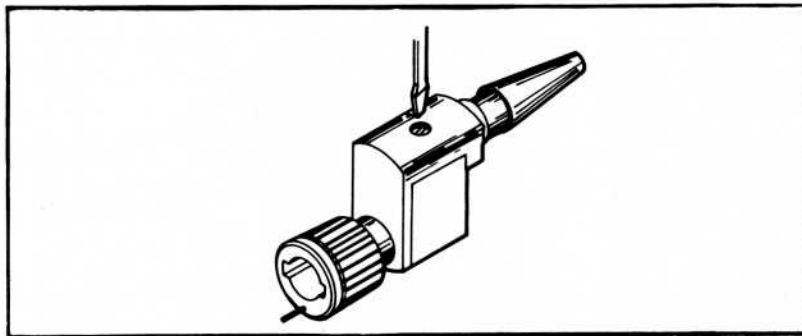

Fig. 4 Low-frequency adjustment.

P6063B PROBE

HIGH-FREQUENCY COMPENSATION

If the P6063B Probe is to be used in observing or measuring sinewaves or pulses with frequency components above 3 MHz, high-frequency compensation should be checked, then adjusted if necessary.

TEST EQUIPMENT REQUIRED

DESCRIPTION	MINIMUM SPECIFICATIONS	EXAMPLES OF APPLICABLE TEST EQUIPMENT
Test oscilloscope	Bandwidth: 225 MHz	Tektronix 475A or 7904 Oscilloscope with 7A16A Amplifier and a 7B70 Time Base.
Pulse or squarewave generator	Risetime: ≤ 1 ns Amplitude: 0.5 V into 50 Ω	Tektronix PG506 ¹ Calibration Generator.
Used With PG506 Only		
Coaxial cable with BNC connectors	Precision 50 Ω	Tektronix P/N 012-0482-00.
10X attenuator with BNC connectors	50 Ω	Tektronix P/N 011-0059-02.
Feedthrough termination with BNC connectors	50 Ω	Tektronix P/N 011-0049-01.
Probe-tip-to-BNC adapter		Tektronix P/N 013-0084-01.

¹ Requires TM500-Series Power Module.

High-Frequency Compensation Procedure

1. Make sure probe attenuation switch is in 10X position.
2. Turn test oscilloscope and signal generator on and allow enough warmup time for equipment to stabilize.
3. Connect positive going (fast rise) output of generator through a precision 50 Ω cable, a 10X attenuator, and a 50 Ω feedthrough termination to test oscilloscope input connector.
4. Set generator repetition rate switch for an output of 100 kHz.
5. Set oscilloscope Time/Div to .02 μ s and Volts/Div to 10 mV.
6. Adjust the generator amplitude control for 5 division pulse amplitude.

7. Note pulse shape and aberrations.
8. Remove $50\ \Omega$ cable, 10X attenuator, and feedthrough termination from generator and test oscilloscope. Install probe on test oscilloscope input connector.
9. Connect positive going (fast rise) output of generator through a $50\ \Omega$ feedthrough termination and a probe-tip to BNC adapter to the probe tip.
10. Check high-frequency response by comparing probe-oscilloscope pulse response against display noted in step 7. Aberrations from reference response should not exceed +3%, -3%, or 5% p-p of pulse amplitude.
11. If aberrations are excessive, proceed as follows:
 - a. Remove compensation box cover.
 - b. Adjust R5 and R6 (also R9 for 6-foot probe) for best overall flat response. See Fig. 5 for adjustment locations.
 - c. Adjust C6 for best corner response (without ringing).
 - d. Repeat step b. and c. as necessary for best waveform.

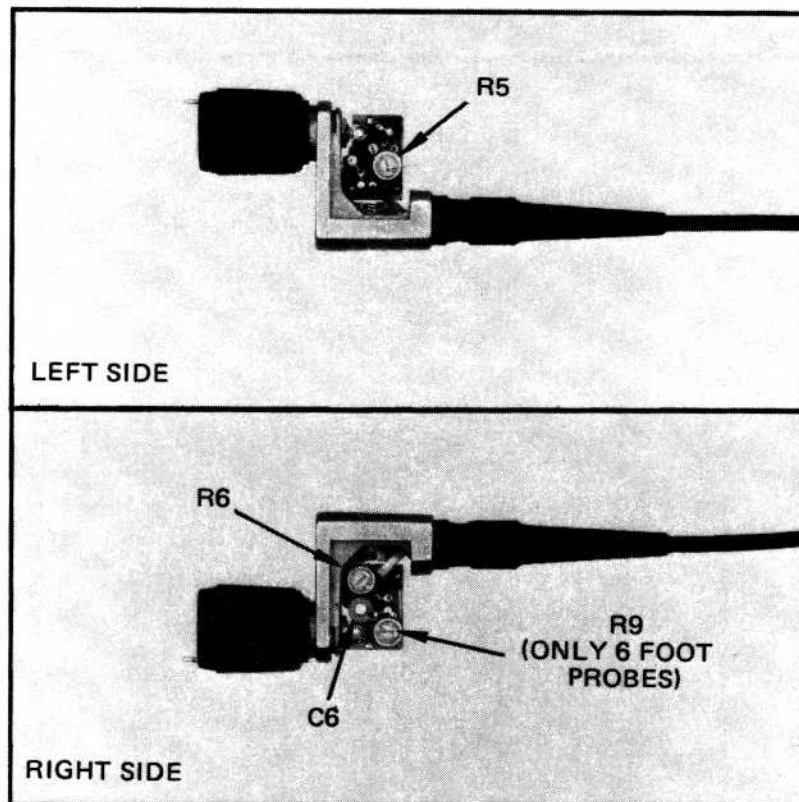

Fig. 5 High-frequency adjustments.

MAINTENANCE

WARNING

To avoid shock, do not disassemble probe when connected to voltage source. Only qualified service personnel should use the following service instructions. Unless you are qualified to do so, perform no servicing except that contained in the preceding operating instructions.

The P6063B Probe is designed to withstand normal operations and handling. However, if the probe assembly fails or breaks, replacement parts are available. See Replacement Parts List for part numbers.

Replacing Units of A Probe Assembly (See Fig. 6)

If the coaxial cable, probe head, compensation box or connector should fail, new assemblies for each may be installed. When replacing these assemblies, make sure to use the proper probe head and compensation box for cable length.

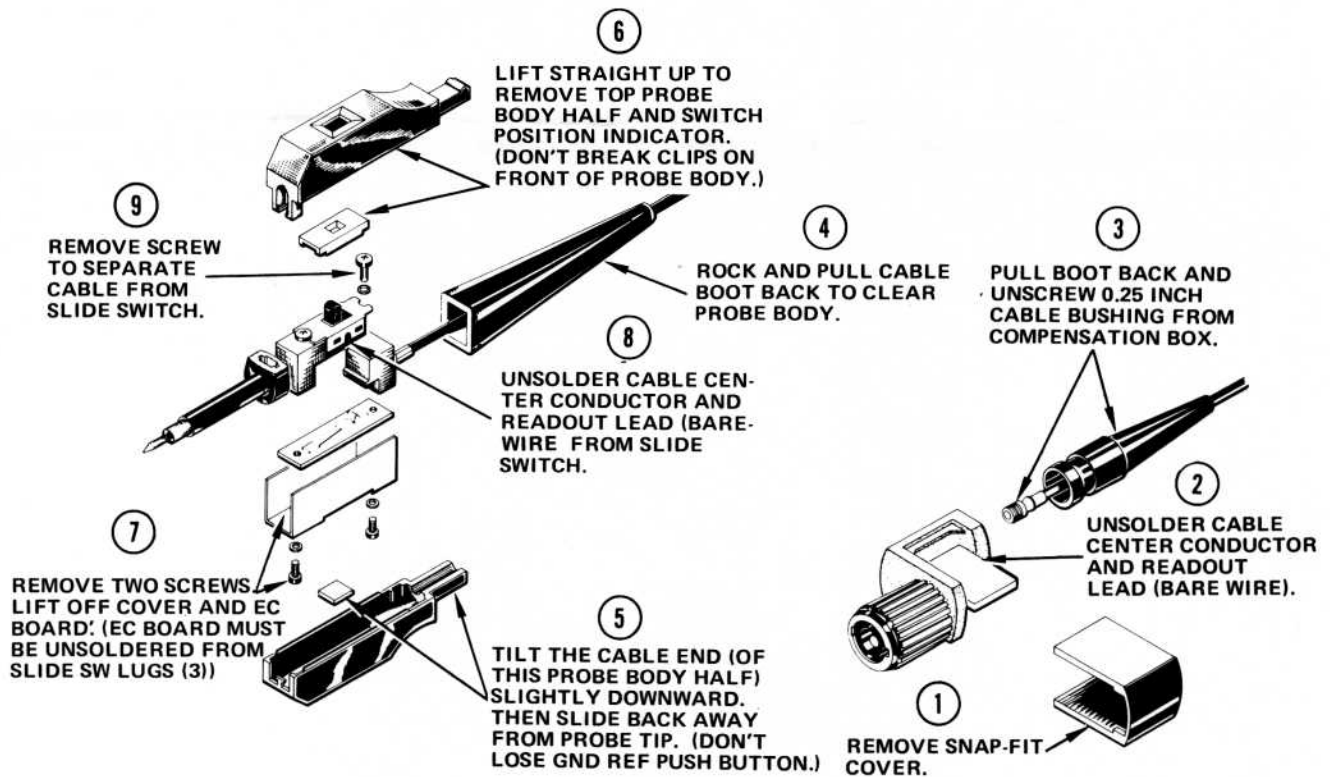
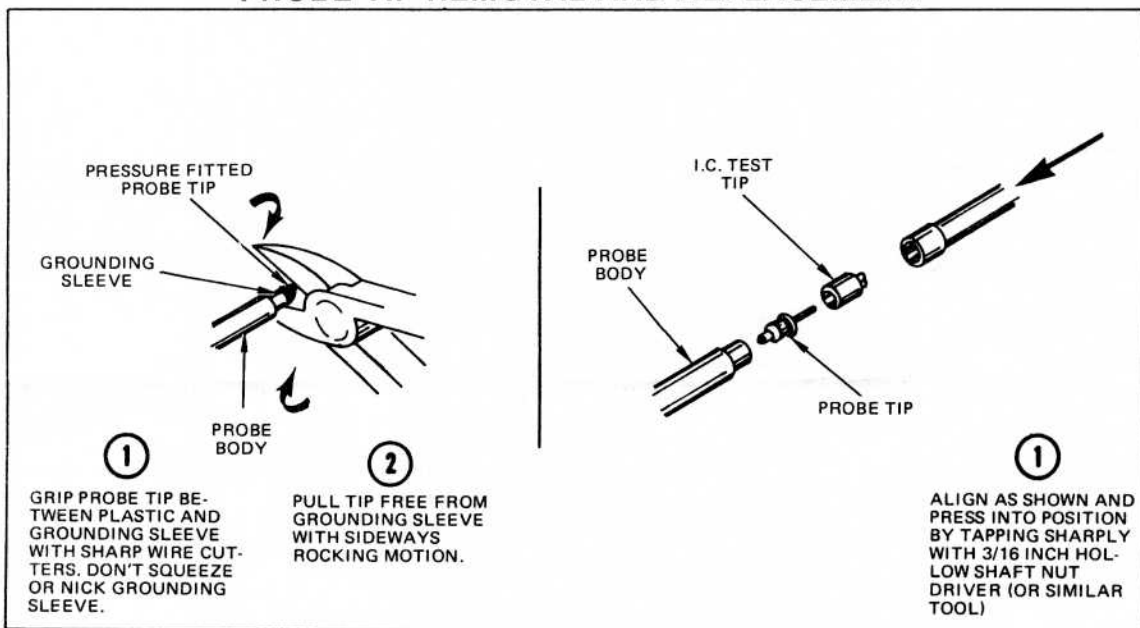

Fig. 6 Replacing units of a probe assembly.

PROBE TIP REMOVAL AND REPLACEMENT



REPLACEABLE PARTS

PARTS ORDERING INFORMATION

Replacement parts are available from or through your local Tektronix, Inc. Field Office or representative.

Changes to Tektronix instruments are sometimes made to accommodate improved components as they become available, and to give you the benefit of the latest circuit improvements developed in our engineering department. It is therefore important, when ordering parts, to include the following information in your order: Part number, instrument type or number, serial number, and modification number if applicable.

If a part you have ordered has been replaced with a new or improved part, your local Tektronix, Inc. Field Office or representative will contact you concerning any change in part number.

Change information, if any, is located at the rear of this manual.

SPECIAL NOTES AND SYMBOLS

- X000 Part first added at this serial number
- 00X Part removed after this serial number

FIGURE AND INDEX NUMBERS

Items in this section are referenced by figure and index numbers to the illustrations.

INDENTATION SYSTEM

This mechanical parts list is indented to indicate item relationships. Following is an example of the indentation system used in the description column.

- ```

1 2 3 4 5 Name & Description
Assembly and/or Component
Attaching parts for Assembly and/or Component
 --- * ---
Detail Part of Assembly and/or Component
Attaching parts for Detail Part
 --- * ---
Parts of Detail Part
Attaching parts for Parts of Detail Part
 --- * ---

```

Attaching Parts always appear in the same indentation as the item it mounts, while the detail parts are indented to the right. Indented items are part of, and included with, the next higher indentation. The separation symbol --- \* --- indicates the end of attaching parts.

**Attaching parts must be purchased separately, unless otherwise specified.**

## ITEM NAME

In the Parts List, an Item Name is separated from the description by a colon (:). Because of space limitations, an Item Name may sometimes appear as incomplete. For further Item Name identification, the U.S. Federal Cataloging Handbook H6-1 can be utilized where possible.

## ABBREVIATIONS

|       |                    |         |                       |          |                      |          |                 |
|-------|--------------------|---------|-----------------------|----------|----------------------|----------|-----------------|
| "     | INCH               | ELECTRN | ELECTRON              | IN       | INCH                 | SE       | SINGLE END      |
| #     | NUMBER SIZE        | ELEC    | ELECTRICAL            | INCAND   | INCANDESCENT         | SECT     | SECTION         |
| ACTR  | ACTUATOR           | ELECTLT | ELECTROLYTIC          | INSUL    | INSULATOR            | SEMICOND | SEMICONDUCTOR   |
| ADPTR | ADAPTER            | ELEM    | ELEMENT               | INTL     | INTERNAL             | SHLD     | SHIELD          |
| ALIGN | ALIGNMENT          | EPL     | ELECTRICAL PARTS LIST | LPHLDR   | LAMPHOLDER           | SHLDR    | SHOULDERED      |
| AL    | ALUMINUM           | EQPT    | EQUIPMENT             | MACH     | MACHINE              | SKT      | SOCKET          |
| ASSEM | ASSEMBLED          | EXT     | EXTERNAL              | MECH     | MECHANICAL           | SL       | SLIDE           |
| ASSY  | ASSEMBLY           | FIL     | FILLISTER HEAD        | MTG      | MOUNTING             | SLFLKG   | SELF-LOCKING    |
| ATTEN | ATTENUATOR         | FLEX    | FLEXIBLE              | NIP      | NIPPLE               | SLVG     | SLEEVING        |
| AWG   | AMERICAN WIRE GAGE | FLH     | FLAT HEAD             | NON WIRE | NOT WIRE WOUND       | SPR      | SPRING          |
| BD    | BOARD              | FLTR    | FILTER                | OBD      | ORDER BY DESCRIPTION | SO       | SQUARE          |
| BRKT  | BRACKET            | FR      | FRAME or FRONT        | OD       | OUTSIDE DIAMETER     | SST      | STAINLESS STEEL |
| BRS   | BRASS              | FR      | FRAME or FRONT        | OVH      | OVAL HEAD            | STL      | STEEL           |
| BRZ   | BRONZE             | FSTNR   | FASTENER              | PH BRZ   | PHOSPHOR BRONZE      | SW       | SWITCH          |
| BSHG  | BUSHING            | FT      | FOOT                  | PL       | PLAIN or PLATE       | T        | TUBE            |
| CAB   | CABINET            | FXD     | FIXED                 | PLSTC    | PLASTIC              | TERM     | TERMINAL        |
| CAP   | CAPACITOR          | GSKT    | GASKET                | PN       | PART NUMBER          | THD      | THREAD          |
| CER   | CERAMIC            | HDL     | HANDLE                | PNH      | PAN HEAD             | THK      | THICK           |
| CHAS  | CHASSIS            | HEX     | HEXAGON               | PWR      | POWER                | TNSN     | TENSION         |
| CKT   | CIRCUIT            | HEX HD  | HEXAGONAL HEAD        | RCPT     | RECEPTACLE           | TPG      | TAPPING         |
| COMP  | COMPOSITION        | HEX SOC | HEXAGONAL SOCKET      | RES      | RESISTOR             | TRH      | TRUSS HEAD      |
| CONN  | CONNECTOR          | HLCP    | HELICAL COMPRESSION   | RGD      | RIGID                | V        | VOLTAGE         |
| COV   | COVER              | HLEXT   | HELICAL EXTENSION     | RLF      | RELIEF               | VAR      | VARIABLE        |
| CPLG  | COUPLING           | HV      | HIGH VOLTAGE          | RTNR     | RETAINER             | W/       | WITH            |
| CRT   | CATHODE RAY TUBE   | IC      | INTEGRATED CIRCUIT    | SCH      | SOCKET HEAD          | WSHR     | WASHER          |
| DEG   | DEGREE             | ID      | INSIDE DIAMETER       | SCOPE    | OSCILLOSCOPE         | XFMR     | TRANSFORMER     |
| DWR   | DRAWER             | IDENT   | IDENTIFICATION        | SCR      | SCREW                | XSTR     | TRANSISTOR      |
|       |                    | IMPLR   | IMPELLER              |          |                      |          |                 |

3.5 FOOT PROBE SCHEMATIC DIAGRAM

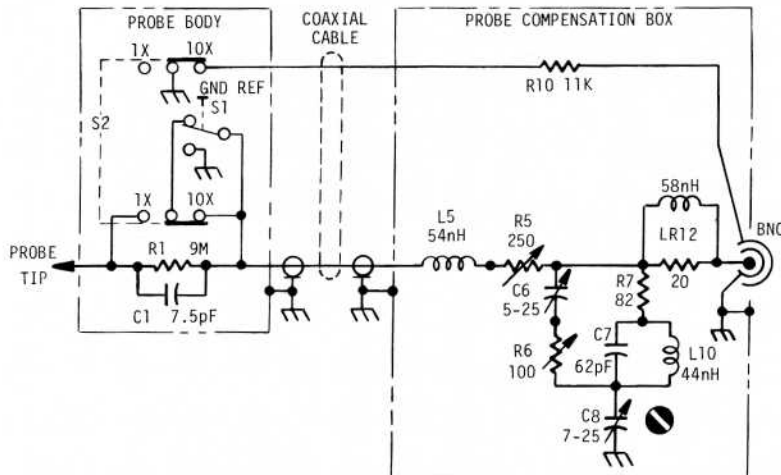

3.5 FOOT PROBE ELECTRICAL PARTS LIST

| Ckt No.         | Tektronix Part No. | Serial/Model No. Eff | Dscont | Name & Description                     | Mfr Code | Mfr Part Number |
|-----------------|--------------------|----------------------|--------|----------------------------------------|----------|-----------------|
| C1 <sup>1</sup> | -----              | -----                |        | CAP., FXD, CER DI:7.5PF,+/-1PF,500V    |          |                 |
| C6              | 281-0123-00        |                      |        | CAP., VAR, CER DI:5-25PF,100V          | 72982    | 518-000A5-25    |
| C7              | 281-0799-00        |                      |        | CAP., FXD, CER DI:62PF,+/-2%,100V      | 04222    | GC70-14620E     |
| C8              | 281-0160-00        |                      |        | CAP., VAR, CER DI:7-25PF,350V          | 72982    | 538-011B7-25    |
| LR12            | 108-0893-00        |                      |        | COIL, RF:FIXED,58NH,ON 20 OHM RESISTOR | 80009    | 108-0893-00     |
| L5              | 108-0643-00        |                      |        | COIL, FXD, RF:54NH                     | 80009    | 108-0643-00     |
| L10             | 108-0892-00        |                      |        | COIL, FXD, RF:44NH                     | 80009    | 108-0892-00     |
| R1 <sup>1</sup> | -----              |                      |        | RES., FXD, FILM:9M OHM,0.1%,0.25W      |          |                 |
| R5              | 311-0978-01        |                      |        | RES., VAR, NONWIR:250 OHM,10%,0.50W    | 80294    | 3329HH78-251    |
| R6              | 311-0622-01        |                      |        | RES., VAR, NONWIR:100 OHM,10%,0.50W    | 32997    | 3326H-K28-101   |
| R7              | 317-0820-00        |                      |        | RES., FXD, CMPSN:82 OHM,5%,0.125W      | 01121    | BB8205          |
| R10             | 317-0113-00        |                      |        | RES., FXD, CMPSN:11K OHM,5%,0.125W     | 01121    | BB1135          |
| S2              | 260-1470-03        |                      |        | SWITCH, SLIDE:DPDT,0.5A,125VAC         | 80009    | 260-1470-03     |

<sup>1</sup>Available as assembly 206-0210-00 only.

**P6063B PROBE**

**6 FOOT PROBE SCHEMATIC DIAGRAM**

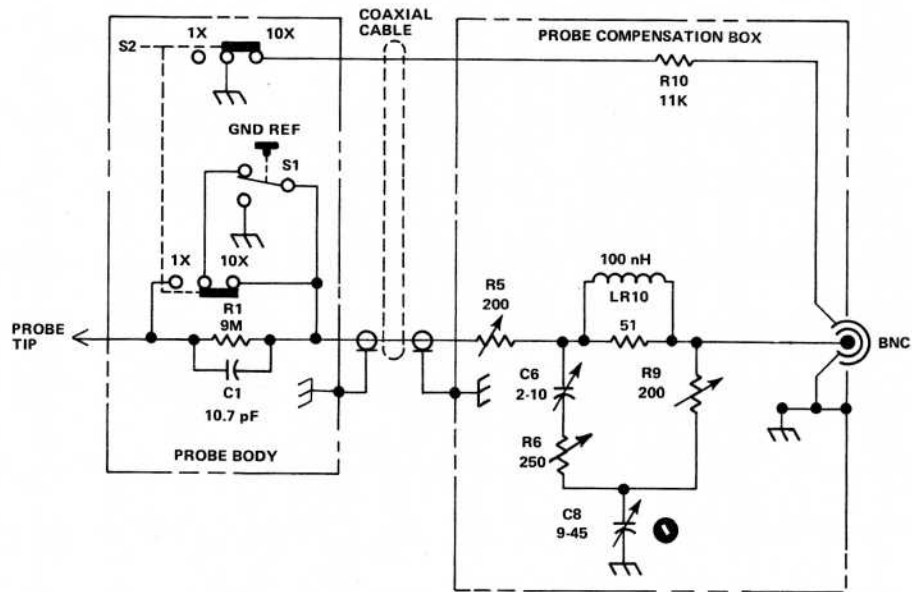

**6 FOOT PROBE ELECTRICAL PARTS LIST**

| Ckt No.         | Tektronix Part No. | Serial/Model No. Eff | Dscont | Name & Description                      | Mfr Code | Mfr Part Number  |
|-----------------|--------------------|----------------------|--------|-----------------------------------------|----------|------------------|
| C1 <sup>1</sup> | -----              | -----                |        | CAP., FXD, CER DI:10.7PF,1%,500V        |          |                  |
| C6              | 281-0221-00        |                      |        | CAP., VAR, CER DI:2-10PF,100V           | 72982    | 513-001-A-2.0-10 |
| C8              | 281-0167-00        |                      |        | CAP., VAR, CER DI:9-45PF,200V           | 72982    | 538-011-D 9-45   |
| LR10            | 108-0408-00        |                      |        | COIL, FXD, RF:100NH, ON 51 OHM RESISTOR | 80009    | 108-0408-00      |
| R1 <sup>1</sup> | -----              | -----                |        | RES., FXD, FILM:9M OHM, 0.1%, 0.25W     |          |                  |
| R5              | 311-0605-01        |                      |        | RES., VAR, NONWIR:200 OHM, 10%, 0.50W   | 73138    | 82P-3-0-201      |
| R6              | 311-0978-01        |                      |        | RES., VAR, NONWIR:250 OHM, 10%, 0.50W   | 80294    | 3329HH78-251     |
| R9              | 311-0605-01        |                      |        | RES., VAR, NONWIR:200 OHM, 10%, 0.50W   | 73138    | 82P-3-0-201      |
| R10             | 317-0113-00        |                      |        | RES., FXD, CMPSN:11K OHM, 5%, 0.125W    | 01121    | BB1135           |
| S2              | 260-1470-03        |                      |        | SWITCH, SLIDE:DPDT, 0.5A, 125VAC        | 80009    | 260-1470-03      |

<sup>1</sup>Available as assembly 206-0212-00 only.

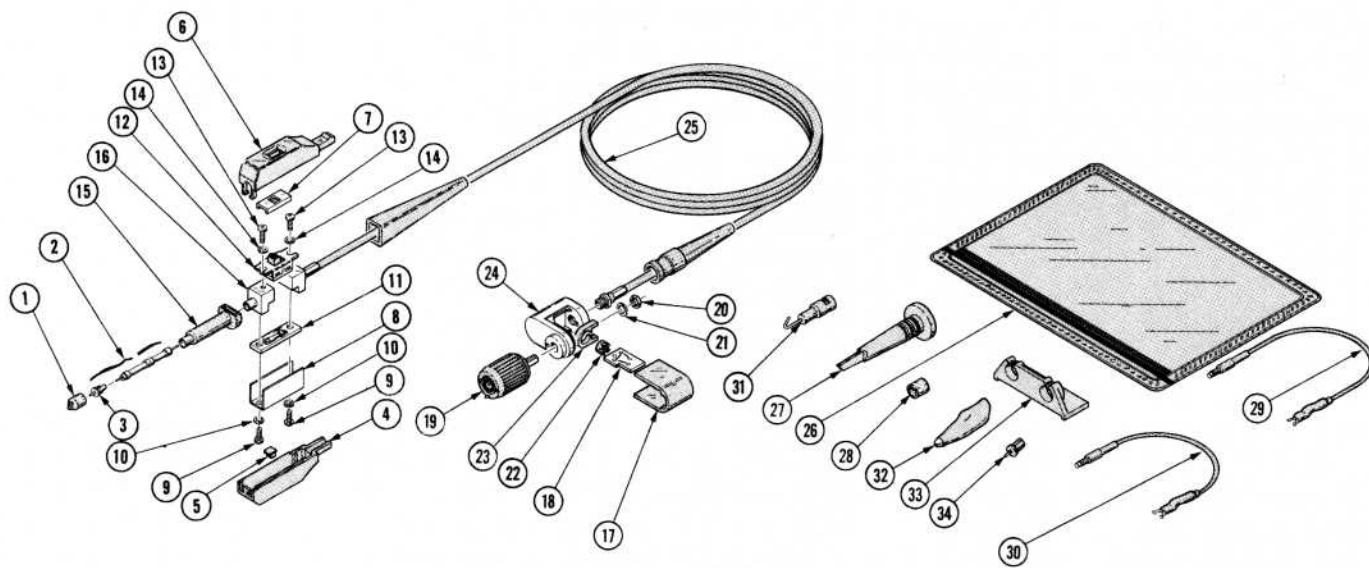

REPLACEABLE PARTS LIST

| Fig. & Index No. | Tektronix Part No. | Serial/Model No. Eff Dscont | Qty | 1 | 2 | 3 | 4 | 5 | Name & Description                                | Mfr Code | Mfr Part Number |
|------------------|--------------------|-----------------------------|-----|---|---|---|---|---|---------------------------------------------------|----------|-----------------|
| 3.5 FOOT PROBE   |                    |                             |     |   |   |   |   |   |                                                   |          |                 |
|                  | 010-6063-11        |                             | 1   |   |   |   |   |   | LEAD,TEST:42.0 L W/ACCESSORIES                    | 80009    | 010-6063-11     |
|                  | 010-6063-10        |                             | 1   |   |   |   |   |   | LEAD,TEST:42.0 L                                  | 80009    | 010-6063-10     |
| -1               | -----              |                             | 1   |   |   |   |   |   | TIP,TEST PROD:IC TEST                             |          |                 |
|                  | -----              |                             | -   |   |   |   |   |   | (AVAILABLE IN PACKS OF 10, P.N. 015-0201-04       |          |                 |
|                  | -----              |                             | -   |   |   |   |   |   | OR 100 P.N. 015-0201-05)                          |          |                 |
| -2               | 206-0210-00        |                             | 1   |   |   |   |   |   | ATTEN SUBASSY:                                    | 80009    | 206-0210-00     |
| -3               | -----              |                             | 1   |   |   |   |   |   | TIP,TEST PROD:W/BODY                              |          |                 |
|                  | -----              |                             | -   |   |   |   |   |   | (AVAILABLE IN PACKS OF 10, PART                   |          |                 |
|                  | -----              |                             | -   |   |   |   |   |   | NUMBER 206-0191-03)                               |          |                 |
|                  | -----              |                             | 1   |   |   |   |   |   | CAP.,FXD,CER DI:(C1 EPL)                          |          |                 |
|                  | -----              |                             | 1   |   |   |   |   |   | RES.,FXD,FILM:(R1 EPL)                            |          |                 |
| -4               | 204-0596-03        |                             | 1   |   |   |   |   |   | BODY HALF,PROBE:BOTTOM                            | 80009    | 204-0596-03     |
| -5               | 366-1529-01        |                             | 1   |   |   |   |   |   | PUSH BUTTON:BLACK                                 | 80009    | 366-1529-01     |
| -6               | 204-0595-00        |                             | 1   |   |   |   |   |   | BODY HALF,PROBE:                                  | 80009    | 204-0595-00     |
| -7               | 214-2041-00        |                             | 1   |   |   |   |   |   | IND,SWITCH POSN:                                  | 80009    | 214-2041-00     |
| -8               | 337-2380-00        |                             | 1   |   |   |   |   |   | SHIELD,ELEC:PROBE                                 | 80009    | 337-2380-00     |
|                  |                    |                             |     |   |   |   |   |   | (ATTACHING PARTS)                                 |          |                 |
| -9               | 211-0264-00        |                             | 2   |   |   |   |   |   | SCREW,MACHINE:2-56 X 0.156 INCH,PNH,SST           | 83385    | 0BD             |
| -10              | 210-0080-00        |                             | 2   |   |   |   |   |   | WASHER,LOCK:SPLIT 0.091 ID X 0.172" OD,SST        | 86928    | 0BD             |
|                  |                    |                             |     |   |   |   |   |   | * - - - -                                         |          |                 |
| -11              | 670-4797-00        |                             | 1   |   |   |   |   |   | CKT BOARD ASSY:GROUND REFERENCE SWITCH            | 80009    | 670-4797-00     |
| -12              | -----              |                             | 1   |   |   |   |   |   | SWITCH,SLIDE:(S2 EPL)                             |          |                 |
|                  |                    |                             |     |   |   |   |   |   | (ATTACHING PARTS)                                 |          |                 |
| -13              | 211-0264-00        |                             | 2   |   |   |   |   |   | SCREW,MACHINE:2-56 X 0.156 INCH,PNH,SST           | 83385    | 0BD             |
| -14              | 210-0080-00        |                             | 2   |   |   |   |   |   | WASHER,LOCK:SPLIT 0.091 ID X 0.172" OD,SST        | 86928    | 0BD             |
|                  |                    |                             |     |   |   |   |   |   | * - - - -                                         |          |                 |
| -15              | 204-0598-00        |                             | 1   |   |   |   |   |   | BODY,PROBE:                                       | 80009    | 204-0598-00     |
| -16              | 343-0447-00        |                             | 1   |   |   |   |   |   | COLLAR,GND CLIP:                                  | 80009    | 343-0447-00     |
| -17              | 200-1158-17        |                             | 1   |   |   |   |   |   | COVER,COMP BOX:                                   | 80009    | 200-1158-17     |
| -18              | 670-3259-01        |                             | 1   |   |   |   |   |   | CKT BOARD ASSY:PROBE                              | 80009    | 670-3259-01     |
| -19              | 131-1070-00        |                             | 1   |   |   |   |   |   | CONNECTOR,PLUG,:BNC                               | 80009    | 131-1070-00     |
|                  |                    |                             |     |   |   |   |   |   | (ATTACHING PARTS)                                 |          |                 |
| -20              | 220-0572-00        |                             | 1   |   |   |   |   |   | NUT,PLAIN,HEX.:10-32 X 0.25 INCH,PL BRS           | 73743    | 0BD             |
| -21              | 210-0056-00        |                             | 1   |   |   |   |   |   | WASHER,LOCK:SPLIT 0.195 ID X 0.32" OD,PL BRZ83385 | 83385    | 0BD             |
|                  |                    |                             |     |   |   |   |   |   | * - - - -                                         |          |                 |
| -22              | -----              |                             | 1   |   |   |   |   |   | CAP.,VAR,CER DI:(C8 EPL)                          |          |                 |
| -23              | 354-0396-00        |                             | 1   |   |   |   |   |   | RING,CAP.MTG:                                     | 80009    | 354-0396-00     |
| -24              | 426-0690-04        |                             | 1   |   |   |   |   |   | FRAME,CMPNT BOX:                                  | 80009    | 426-0690-04     |
| -25              | 175-1499-00        |                             | 1   |   |   |   |   |   | CA ASSY,SP,ELEC:                                  | 80009    | 175-1499-00     |

**P6063B PROBE**

| Fig. & Index No.     | Tektronix Part No. | Serial/Model No. Eff Dscont | Qty | 1 | 2 | 3 | 4 | 5 | Name & Description                              | Mfr Code | Mfr Part Number |
|----------------------|--------------------|-----------------------------|-----|---|---|---|---|---|-------------------------------------------------|----------|-----------------|
| 6 FOOT PROBE         |                    |                             |     |   |   |   |   |   |                                                 |          |                 |
|                      | 010-6063-13        |                             | 1   |   |   |   |   |   | LEAD,TEST:72.0 L,W/ACCESSORIES                  | 80009    | 010-6063-13     |
|                      | 010-6063-12        |                             | 1   |   |   |   |   |   | . LEAD,TEST:72.0 L                              | 80009    | 010-6063-12     |
| -1                   | -----              |                             | 1   |   |   |   |   |   | . . TIP,TEST PROD:IC TEST                       |          |                 |
|                      | -----              |                             | -   |   |   |   |   |   | . . (AVAILABLE IN PACKS OF 10, PART NUMBER      |          |                 |
|                      | -----              |                             | -   |   |   |   |   |   | . . 015-0201-04 OR 100 PART NUMBER 015-0201-05) |          |                 |
| -2                   | 206-0212-00        |                             | 1   |   |   |   |   |   | . . ATTEN SUBASSY:                              | 80009    | 206-0212-00     |
| -3                   | -----              |                             | 1   |   |   |   |   |   | . . . TIP,TEST PROD:W/BODY                      |          |                 |
|                      | -----              |                             | 1   |   |   |   |   |   | . . . CAP.,FXD,CER:(C1 EPL)                     |          |                 |
|                      | -----              |                             | 1   |   |   |   |   |   | . . . RES.,FXD,FILM:(R1 EPL)                    |          |                 |
| -4                   | 204-0596-03        |                             | 1   |   |   |   |   |   | . . BODY HALF,PROBE:BOTTOM                      | 80009    | 204-0596-03     |
| -5                   | 366-1529-01        |                             | 1   |   |   |   |   |   | . . PUSH BUTTON:BLACK                           | 80009    | 366-1529-01     |
| -6                   | 204-0595-00        |                             | 1   |   |   |   |   |   | . . BODY HALF,PROBE:TOP                         | 80009    | 204-0595-00     |
| -7                   | 214-2041-00        |                             | 1   |   |   |   |   |   | . . IND,SWITCH POSN:                            | 80009    | 214-2041-00     |
| -8                   | 337-2380-00        |                             | 1   |   |   |   |   |   | . . SHIELD,ELEC:PROBE                           | 80009    | 337-2380-00     |
|                      |                    |                             |     |   |   |   |   |   | (ATTACHING PARTS)                               |          |                 |
| -9                   | 211-0264-00        |                             | 2   |   |   |   |   |   | . . SCREW,MACHINE:2-56 X 0.156 L,PNH,SST,POZ    | 83385    | OBD             |
| -10                  | 210-0080-00        |                             | 2   |   |   |   |   |   | . . WASHER,LOCK:#2 SPLIT,0.015WASHER,LOCK       | 86928    | OBD             |
|                      |                    |                             |     |   |   |   |   |   | - - - * - - -                                   |          |                 |
| -11                  | 670-4797-00        |                             | 1   |   |   |   |   |   | . . CKT BOARD ASSY:GROUND REFERENCE SWITCH      | 80009    | 670-4797-00     |
| -12                  | -----              |                             | 1   |   |   |   |   |   | . . SWITCH,SLIDE:(S2 EPL)                       |          |                 |
|                      |                    |                             |     |   |   |   |   |   | (ATTACHING PARTS)                               |          |                 |
| -13                  | 211-0264-00        |                             | 2   |   |   |   |   |   | . . SCREW,MACHINE:2-56 X 0.156 L,PNH,SST,POZ    | 83385    | OBD             |
| -14                  | 210-0080-00        |                             | 2   |   |   |   |   |   | . . WASHER,LOCK:#2 SPLIT,0.015WASHER,LOCK       | 86928    | OBD             |
|                      |                    |                             |     |   |   |   |   |   | - - - * - - -                                   |          |                 |
| -15                  | 204-0598-00        |                             | 1   |   |   |   |   |   | . . BODY,PROBE:INNER REAR                       | 80009    | 204-0598-00     |
| -16                  | 343-0447-00        |                             | 1   |   |   |   |   |   | . . COLLAR,GND CLIP:0.24 ID X 0.175,ACETAL      | 80009    | 343-0447-00     |
| -17                  | 200-1158-15        |                             | 1   |   |   |   |   |   | . . COVER,COMP BOX:                             | 80009    | 200-1158-15     |
| -18                  | 670-3260-01        |                             | 1   |   |   |   |   |   | . . CKT BOARD ASSY:PROBE                        | 80009    | 670-3260-01     |
| -19                  | 131-1070-00        |                             | 1   |   |   |   |   |   | . . CONNECTOR,PLUG,:BNC                         | 80009    | 131-1070-00     |
|                      |                    |                             |     |   |   |   |   |   | (ATTACHING PARTS)                               |          |                 |
| -20                  | 220-0572-00        |                             | 1   |   |   |   |   |   | . . NUT,PLAIN,HEX.:10-32 X 0.25 INCH,PL BR5     | 73743    | OBD             |
| -21                  | 210-0056-00        |                             | 1   |   |   |   |   |   | . . WASHER,LOCK:SPLIT,0.195 ID X 0.32" OD,P BRZ | 83385    | OBD             |
|                      |                    |                             |     |   |   |   |   |   | - - - * - - -                                   |          |                 |
| -22                  | -----              |                             | 1   |   |   |   |   |   | . . CAP.,VAR,CER DI:(C8 EPL)                    |          |                 |
| -23                  | 354-0396-00        |                             | 1   |   |   |   |   |   | . . RING,CAP.MTG:                               | 80009    | 354-0396-00     |
| -24                  | 426-0690-04        |                             | 1   |   |   |   |   |   | . . FRAME,CMPNT BOX:                            | 80009    | 426-0690-04     |
| -25                  | 175-1507-00        |                             | 1   |   |   |   |   |   | . . CABLE ASSY,ELEC:6 FEET LONG                 | 80009    | 175-1507-00     |
| STANDARD ACCESSORIES |                    |                             |     |   |   |   |   |   |                                                 |          |                 |
| -26                  | 016-0521-00        |                             | 1   |   |   |   |   |   | POUCH,ACCESSORY:                                | 05006    | OBD             |
| -27                  | 013-0107-03        |                             | 1   |   |   |   |   |   | TIP,TEST PROD:RET HOOK ASSY                     | 80009    | 013-0107-03     |
| -28                  | 166-0404-01        |                             | 1   |   |   |   |   |   | INS SLV,ELEC:FOR 0.188 DIA PROBE BSHG           | 80009    | 166-0404-01     |
| -29                  | 175-0124-01        |                             | 1   |   |   |   |   |   | LEAD,ELECTRICAL:PROBE GND,5 INCHES LONG         | 80009    | 175-0124-01     |
| -30                  | 175-0263-01        |                             | 1   |   |   |   |   |   | LEAD,ELECTRICAL:PROBE GND,3 INCHES LONG         | 80009    | 175-0263-01     |
| -31                  | 206-0114-00        |                             | 1   |   |   |   |   |   | TIP,PROBE:HOOK                                  | 80009    | 206-0114-00     |
| -32                  | 344-0046-00        |                             | 2   |   |   |   |   |   | CLIP,ELECTRICAL:ALLIGATOR TYPE,W/COVER          | 80009    | 344-0046-00     |
| -33                  | 352-0351-00        |                             | 1   |   |   |   |   |   | HOLDER,PROBE:BLACK                              | 80009    | 352-0351-00     |
| -34                  | -----              |                             | 2   |   |   |   |   |   | TIP,TEST PROD:W/BODY                            |          |                 |
|                      | -----              |                             | -   |   |   |   |   |   | (AVAILABLE IN PACKS OF 10, P.N. 206-0191-03)    |          |                 |
|                      | 062-1675-00        |                             | 1   |   |   |   |   |   | PROBE CARD:                                     | 80009    | 062-1675-00     |
|                      | 062-2928-01        |                             | 1   |   |   |   |   |   | DATA SHEET:P6063B                               |          |                 |

## CROSS INDEX—MFR. CODE NUMBER TO MANUFACTURER

| Mfr. Code | Manufacturer                            | Address                      | City, State, Zip       |
|-----------|-----------------------------------------|------------------------------|------------------------|
| 01121     | ALLEN-BRADLEY COMPANY                   | 1201 2ND STREET SOUTH        | MILWAUKEE, WI 53204    |
| 04222     | AVX CERAMICS, DIVISION OF AVX CORP.     | P O BOX 867, 19TH AVE. SOUTH | MYRTLE BEACH, SC 29577 |
| 05006     | TWENTIETH CENTURY PLASTICS, INC.        | 415 E WASHINGTON BLVD.       | LOS ANGELES, CA 90015  |
| 32997     | BOURNS, INC., TRIMPOT PRODUCTS DIV.     | 1200 COLUMBIA AVE.           | RIVERSIDE, CA 92507    |
| 72982     | ERIE TECHNOLOGICAL PRODUCTS, INC.       | 644 W. 12TH ST.              | ERIE, PA 16512         |
| 73138     | BECKMAN INSTRUMENTS, INC., HELIPOT DIV. | 2500 HARBOR BLVD.            | FULLERTON, CA 92634    |
| 73743     | FISCHER SPECIAL MFG. CO.                | 446 MORGAN ST.               | CINCINNATI, OH 45206   |
| 80009     | TEKTRONIX, INC.                         | P O BOX 500                  | BEAVERTON, OR 97077    |
| 80294     | BOURNS, INC., INSTRUMENT DIV.           | 6135 MAGNOLIA AVE.           | RIVERSIDE, CA 92506    |
| 83385     | CENTRAL SCREW CO.                       | 2530 CRESCENT DR.            | BROADVIEW, IL 60153    |
| 86928     | SEASTROM MFG. COMPANY, INC.             | 701 SONORA AVENUE            | GLENDALE, CA 91201     |