

PRINCIPAL SPECIFICATIONS

Model Number	Frequency Range, GHz	Insertion Loss, dB, Max.	Phase Balance, Max.	Amplitude Balance, dB, Max.	Isolation, dB, Min.	Input Power,* W, Max.	Peak Power, kW, Max.	Internal Dissipation mW, Max.
PDM-23-1.7G	1.0 - 2.5	0.30	3°	0.2	23	6	1	100

*CW input power when used as divider with 1.2:1 VSWR_{out}



General Notes:

1. The PDM-23-1.7G 2-way Power Divider/Combiner covers 1.0 GHz to 2.5 GHz using a multi-section Wilkinson stripline design for good output port isolation and balance.
2. This unit complies with MIL-P-23971 and can be supplied screened for compliance with additional specifications for military and space applications requiring the highest reliability.

GENERAL SPECIFICATIONS

Impedance: 50Ω
 Weight: 7 oz. (196 g) nom.
 Operating Temperature: -55° to +85°C

Package Outline

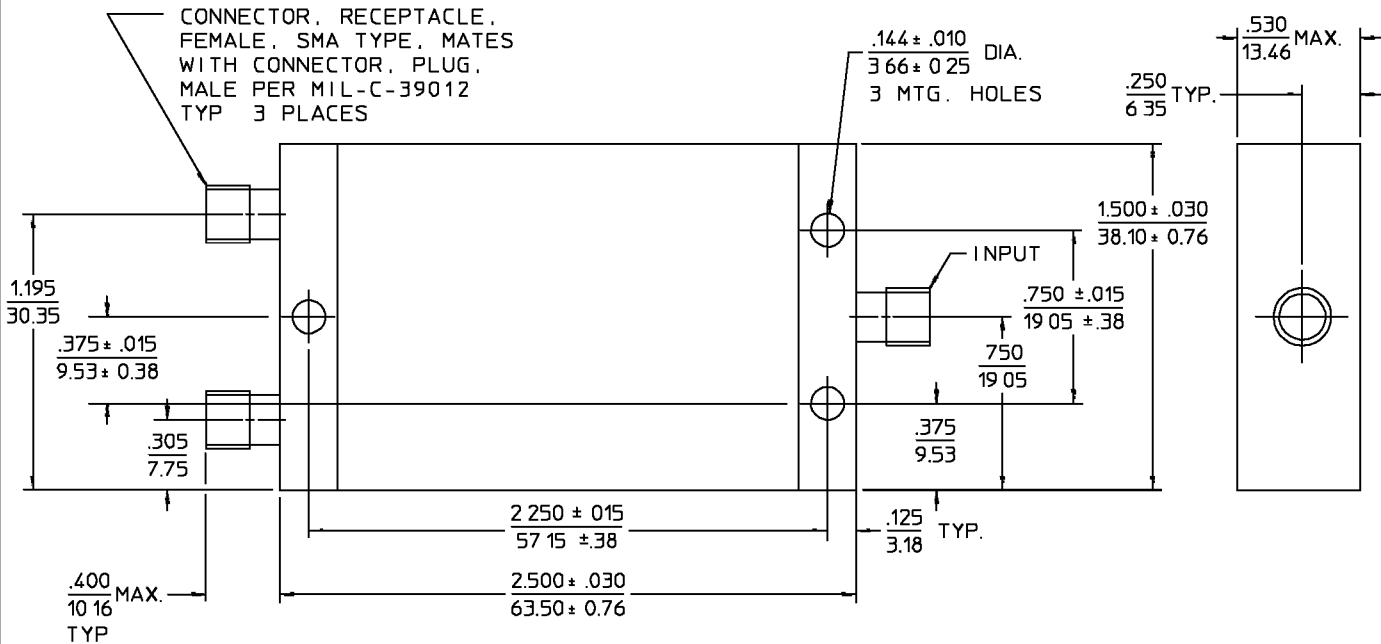

NOTES: 1. Tolerance on 3 place decimals ±.020(.51) except as noted.
 2. Dimensions in inches over millimeters.

29Apr96